

ECO  
STOVE

Wood Fired Hybrid Masonry Heaters



## How It Began

Following the first prototype in 2008, patents were applied for in the UK, USA, Canada, Russia and Europe. Combining age old European and North American technology with modern materials and production practises, Ecco Stoves® are now sold throughout the world.



## Silicon Carbide

The Ecco Stove is produced from a unique mineral in wood fired appliances, Silicon Carbide (SiC). Unlike other appliances, we don't simply clad a metal body in a ceramic material, we build the whole stove out of it.

SiC has many unique properties (it is effectively a mineral sponge) absorbing heat readily but releasing it slowly. It is able to withstand temperatures up to 2000°c and indeed is the second hardest mineral to diamond.



Silicon Carbide Material

Silicon Carbide (SiC) has many other applications including vehicle brake pads, industrial drill bits and electrical conductors.

## Satisfying the toughest of standards

To ensure you get the most from each log while producing the least emissions, the Ecco Stoves have undergone testing to the highest standards. In doing so our models have passed some of the toughest testing requirements worldwide.

Ecco Stoves® are so efficient they will produce less carbon dioxide in combustion than a tree decomposing naturally.

**Please ensure you play your part in a cleaner future by burning your fuel responsibly. We have more information on the best fuel types and storage methods on our website [www.eccostove.com](http://www.eccostove.com)**



# More Than Just A Stove

Having the benefits of both traditional masonry heaters and metal stoves, the Ecco Stove® has evolved to be a hybrid between both styles - having the benefits of slow heat release but projecting its delivered heat much further throughout the home. The heat from an Ecco Stove® will travel much further than traditional steel or cast iron stoves and the lower surface temperature than steel or cast ensures the room the Ecco Stove® stands in is not overheated.

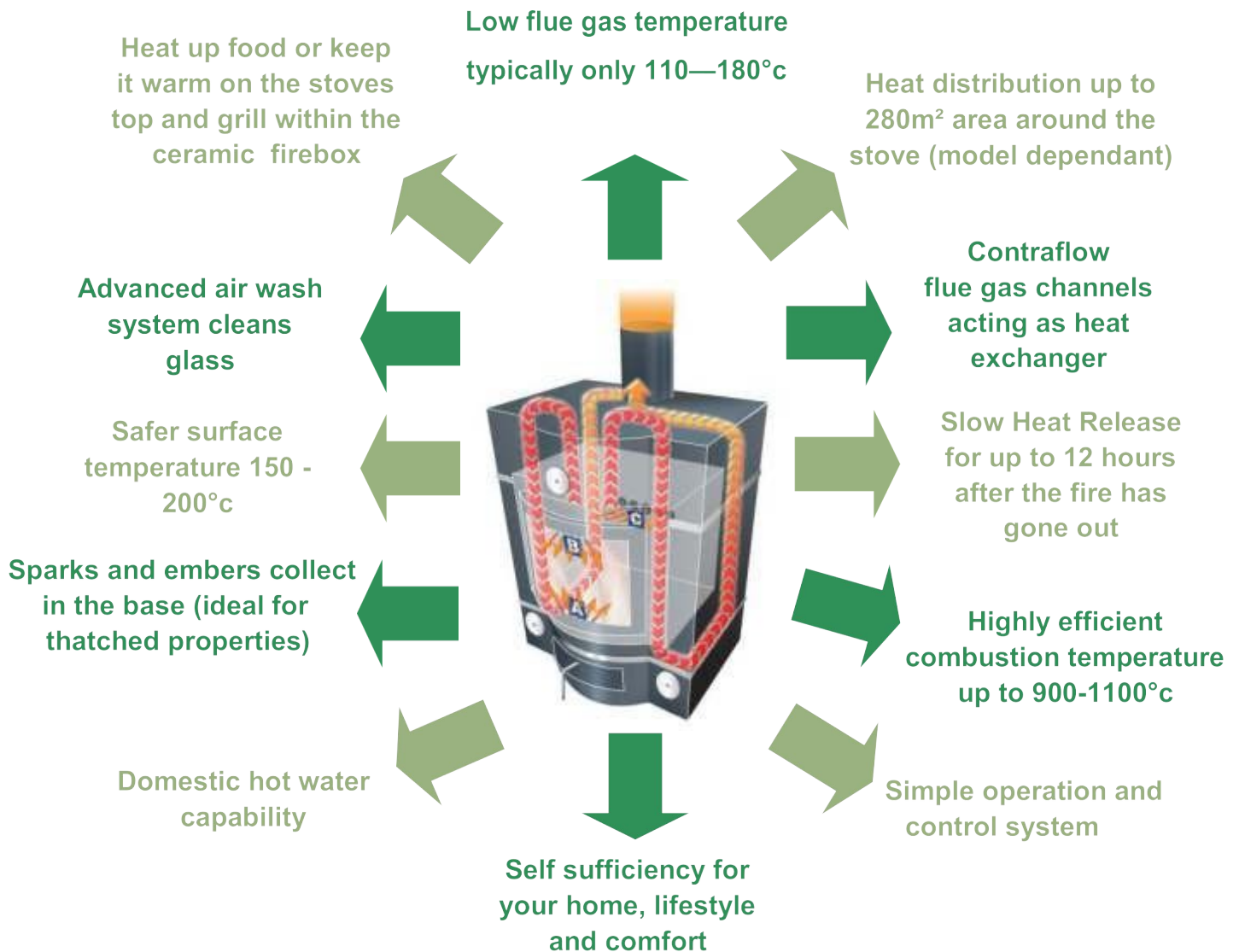

Combining all the points above the Ecco Stove® not only delivers efficiency but performance as well and becoming the heart of any home. Gentle heat waves travel from room to room heating much more of the home than traditional stoves or masonry heaters.

# Heat Retention

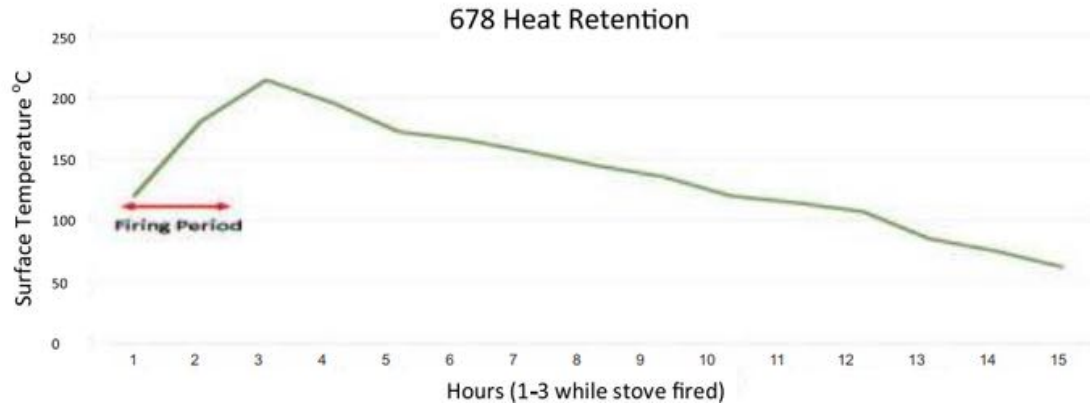

# Heat Flow

Using the benefits of Silicon Carbide and slow heat release from thermal mass the Ecco Stove® gently and continually pushes heat out from the stoves body surface to circulate around the home. Cooler air is naturally drawn back to the stove for warm air recirculation in the stove body. This simple process (as shown in the diagram below) allows warmth to travel much further through the home than traditional cast iron stoves and masonry heaters.

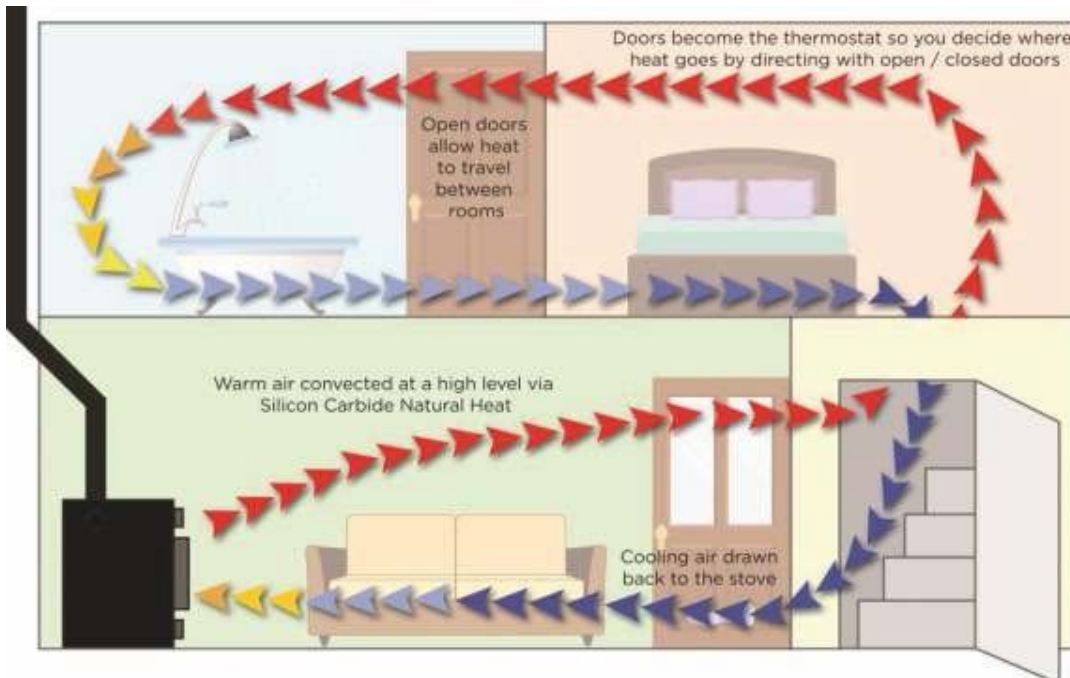

# Heat Plans

To demonstrate what the Ecco Stove® can achieve in your home we are happy to provide a **Heat Plan** estimate. If you are able to fill in the questionnaire on our website, our team will send back a Heat Plan estimate with the recommended stove, temperature bands per room, estimated fuel usage and any advice on optimising performance. We can then visit your home to provide a quote for installation, we will guarantee the Heat Plan we produce specifically for your home.

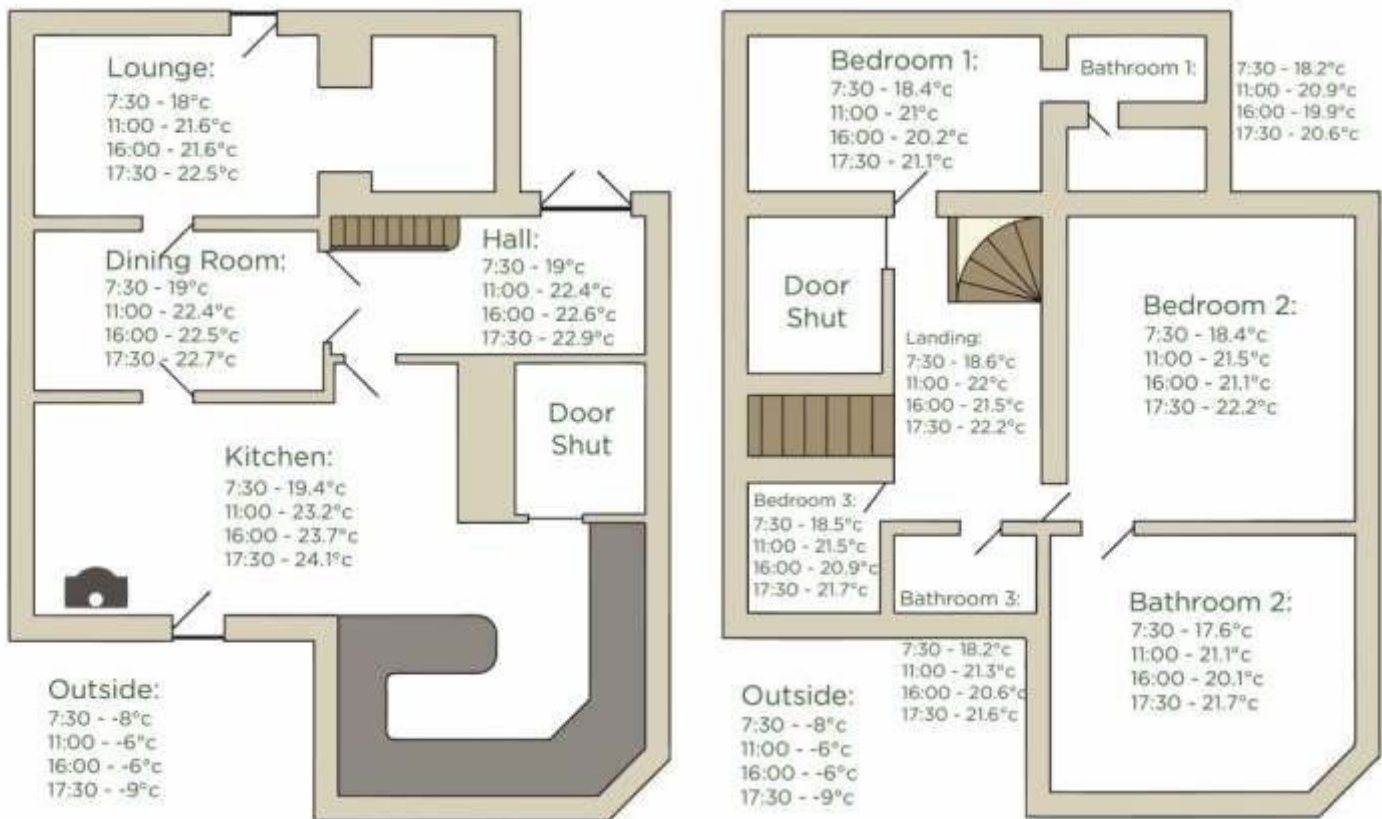

The plans above demonstrate the heating capabilities of our E678 taken from testing carried out in 280m<sup>2</sup> 1640s Cotswold Stone property near Stratford Upon Avon, UK. With air being constantly circulated the property has been heated primarily using an Ecco Stove® E678.

The unique properties of Ecco Stove® provide an alternative to gas, oil and electricity for properties in both on and off grid locations.



# How To Order

## 1. Get a Heat Plan Estimate

Fill in the questionnaire in your free information pack or send us an email with your floor plans

## 2. Contact us for a shipping quote

Get in contact with our team to request a cost for shipping. Do note, customs and taxes may be applicable.

## 3. Choose your stove

Our customer service team can help guide you to the right stove for your needs and property.

## 4. Choose your colour

You can select from a range of colour choices and variations to make your stove unique.

## 5. Place your order

You can order via email at [sales@eccostove.com](mailto:sales@eccostove.com) or give our office a call to process your order.

## 6. Enjoy your warmth

Sit back and enjoy the unique warmth of an Ecco Stove as it envelopes your living space and transforms your home.





“We purchased the Ecco Stove® 678 in September 2018 and it’s been used nearly every day since. The stove has transformed our 4 bed grade 2 listed cottage from being quite cold through the winter into a lovely warm and cosy cottage. We have not needed to use the central heating at all. It is also so easy to use and keep clean, so much easier than our previous cast iron log burner. It’s a pleasure dealing with a company who are so professional in what they do, both before and after the installation.”

*David - UK*

678 in Flat black all over

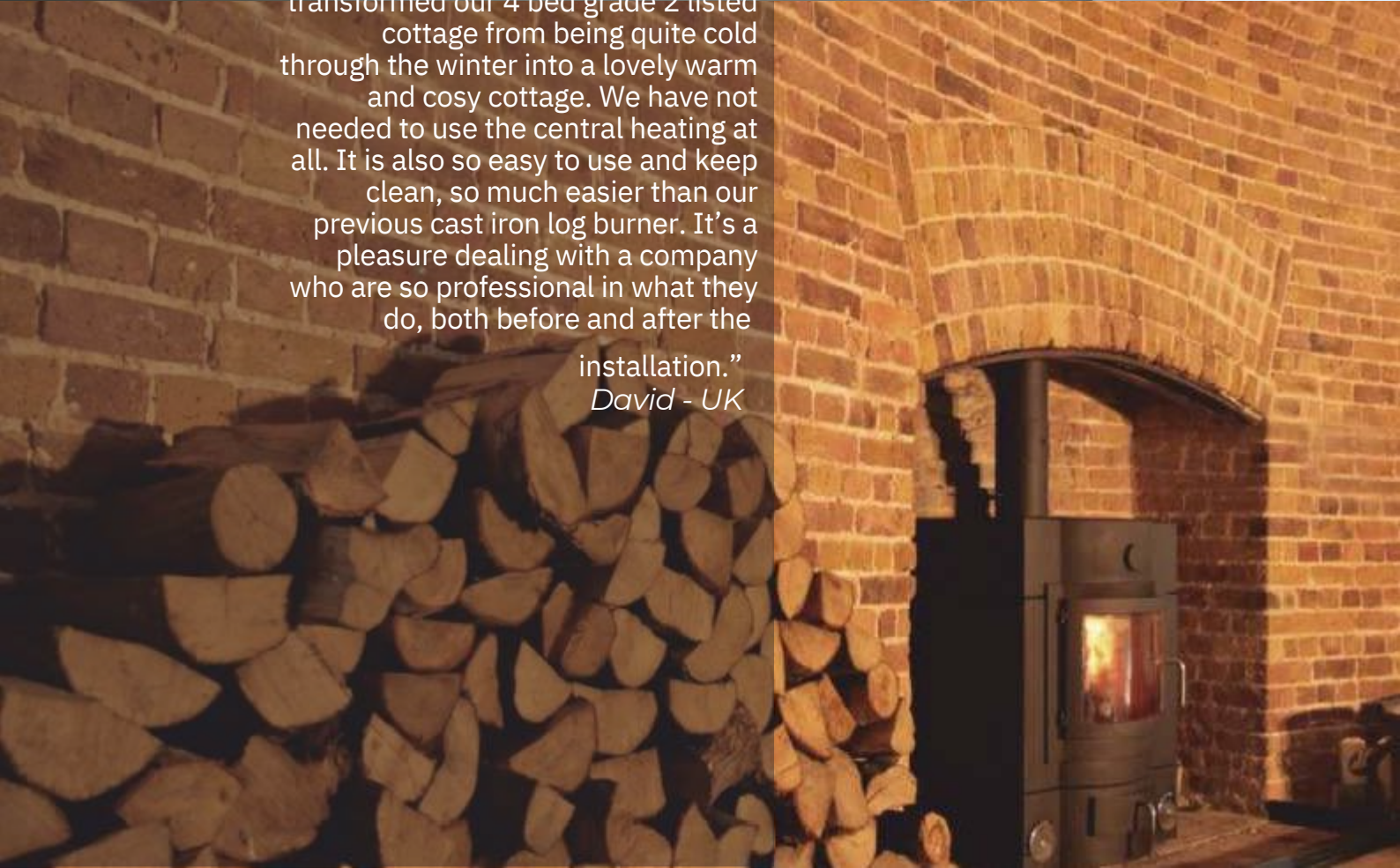



678 in Flat Black paint finish with alloy trims and front plugs

Combining timeless design with balanced heat retention and distribution, the 678 is the most popular model in the range. With a rectangular body and curved front its unique features can be adapted to either traditional or modern settings simply by selecting from our range of colour and trim options.

### Key Features

Natural Heat	Natural Heat	Output	Efficiency   Class	Heat Retention	Log Length
Up to 240m <sup>2</sup>   2583ft <sup>2</sup>	Up to 12 Rooms	10.3kw   35020 BTU	– A -A+ (*Slow Heat Release)	Up to 12.3 Hours	420mm   16

Eco Design Compliant: **EC678**





Defra Exempt: **Yes**

### Options

	Warm Air	Hot Water	External Air	Extension	Heat Shield
Available	Yes	Yes	Yes	Yes	Yes

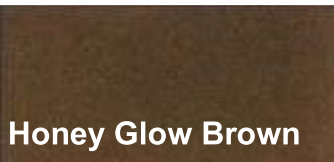
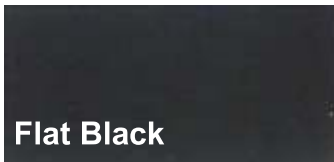
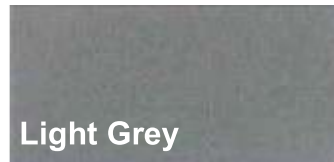
Minimum Opening Size\*: Height 1158mm / 45<sup>1/2</sup> x Width 828mm / 32<sup>1/2</sup>

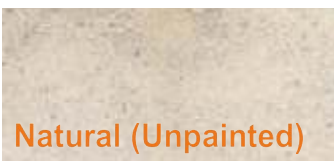
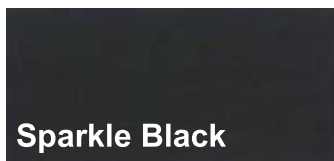
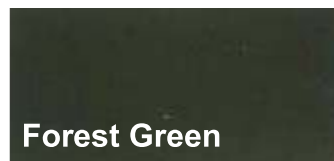
Colours - One or more per stove.

 Honey Glow Brown	 Flat Black	 Light Grey	 Metallic Blue
 Natural (Unpainted)	 Sparkle Black	 Forest Green	 Mojave red





“You installed our stove earlier this year and I thought I’d let you know that we ‘love it’. It is a real focal point of our home and everyone who has seen it comments on it. We have a lot of stove envy from our friends! It’s extremely effective at heating our whole house, including up to our bedroom which is two floors up in the attic. The stove gives off a lot of heat and is still warm in the morning. It is easy to set the fire and once up to the best temperature, it is easy to maintain the heat. Our dogs can’t get close enough.”

*Mr & Mrs B - UK*





The original Ecco Stove® and largest of the range. For larger properties and open or public spaces the 850 becomes the heart of the area and a constant source of warmth. With a similar design to the 678, this model can be styled to any living space using our range of colours.

### Key Features

Natural Heat	Natural Heat	Output	Efficiency   Class	Heat Retention	Log Length
Up to 280m <sup>2</sup>   3000ft <sup>2</sup>	Up to 15 Rooms	11.5kw   38000 BTU	85.3%   A+	Up to 7 Hours	483mm

### Options

	Warm Air	Hot Water	External Air	Extension	Heat Shield
Available	No	No	Yes	No	Yes

Minimum Opening Size\*: Height 1400mm / 55<sup>1/4</sup> x Width 1000mm / 39<sup>3/8</sup>  
 Colours - One or more per stove.

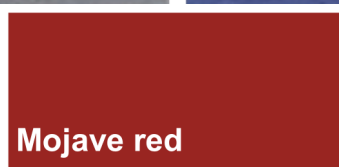
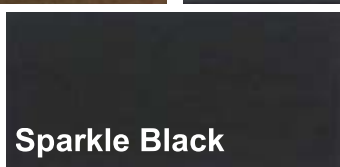
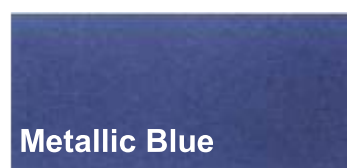
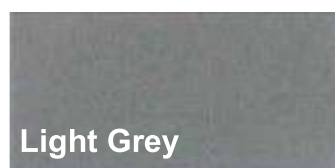
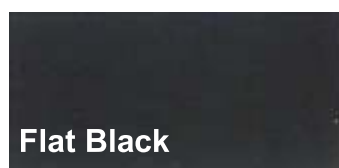
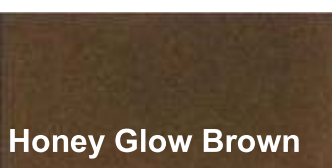

# Our most versatile stove - EC678

Extension Unit

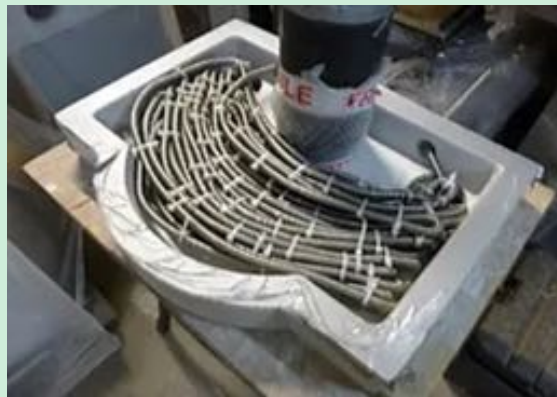

Hotbox for DHW/  
Warm Air Ducting

Trim Option



Heat Shield



Cook Grate

# Technical Specifications

Dimensions	678	850
Height	884mm   34 3/4"	1120mm   44"
Width	678mm   26 3/4"	850mm   33 1/2"
Depth	525mm   20 3/4"	540mm   21 1/4"
Log Length	420mm   16 1/2"	483mm   19"
Weight	550kg   1212lbs	800kg   1763lbs

## Output | Retention | Efficiency

	678	850
KW	10.3	11.5
BTU	35,020	38,000
MJ Stored	114	134
Heat Storage Hrs	12.3 @ 25%	7 @ 25%
Heats Up To	240m <sup>2</sup>   2583ft <sup>2</sup>	280m <sup>2</sup>   3000ft <sup>2</sup>
Rooms Heated	Up to 12	Up to 15
Efficiency   Class	83.9 – 88%*   A - A+ *Slow Heat Release	85.3%   A+

## Clearance To Non Combustibles

	678	850
Top	125mm   4 7/8"	150mm   5 7/8"
Sides	125mm   4 7/8"	125mm   4 7/8"
Rear	75mm   3"	75mm   3"
Front	300mm   11 3/4"	300mm   11 3/4"

## Clearance To Combustibles

	678	850
Top	350mm   13 3/4"	350mm   13 3/4"
Sides	450mm   17 3/4"	600mm   23 5/8"
Rear	350mm   13 3/4"	600mm   23 5/8"
Front	400mm   15 3/4"	400mm   15 3/4"

## Flue Information

	678	850
Centre flue from rear of stove	136mm   55/14"	115mm   41/2"
Flue Size	150mm   6"	150mm   6"

# OUR CUSTOMERS SAY IT BEST...



*Natural heat for your home*



We are loving our Ecco Stove!! We had a Blaze King Stove that failed due to running too hot...We then looked into building a masonry heater but the cost was astronomical and would not be a good return in investment when the house would eventually be sold...We did some research and found the Ecco Stove and we liked the fact that it burns hot and will radiate heat out like a masonry heater.

The best combination! We now have our Ecco Stove E850 installed in the basement of our 1700 Square foot bungalow...We live in Alberta, Canada and the winters get very cold. When we have the stove running and the outside temperature is in the -10C to - 20C range we can keep the house temperature at 22C during the day and about 20C when we wake up in the morning...The help we have received from Ecco Stove in getting the unit brought in, installed and up and running has been fabulous! We are so happy with our stove to date and we would recommend Ecco Stove to anyone who is looking for something better than a common woodstove!



**- Brad, Canada, 2023**

**ECO  
STOVE**



Copyright Ecco Stove © 2024

**Ecco Stove Ltd** ®

2 Redditch Rd, Studley

Warwickshire

B80 7AX

+183 355 93721

sales@eccostove.com



Ecco Stove



Like our Facebook  
page Ecco Stove



@eccostove

[www.eccostove.com](http://www.eccostove.com)

LIKE | FOLLOW | SUBSCRIBE